



GENERAL TECHNOLOGIES, INC.

GTI WANTS TO BE YOUR REBAR SUPPORT PROVIDER

GTI Composite Bar Supports Offer

Superior Strength

- *CRSI approved*
- *exceeds DOT requirements*
- *superior strength over metal supports*

Corrosion Proof

- *ultimate rust protection*
- *surpasses all salt-spray test requirements*
- *outperforms 100 year design standard*
- *epoxy and stainless bar supports
become obsolete*

Green - Green - Green

- *our composite bar supports are 99% green*
- *LEED point recognition*

Buy American by GTI

- *competitively priced*
- *eliminate imports*
- *lower inventory position*
- *next day delivery service*

With American Materials





GTI Bar Supports

260 series GTI Slab Bolster Upper



209 series GTI Composite Slab/Beam Bolster



216 series GTI PC Chair w/sand plate

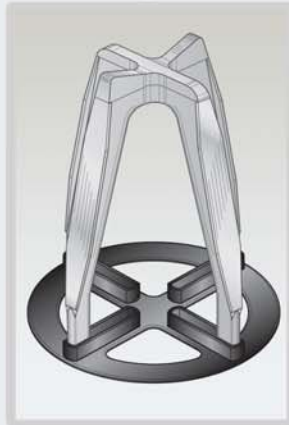

291 series GTI Composite Stack Chair

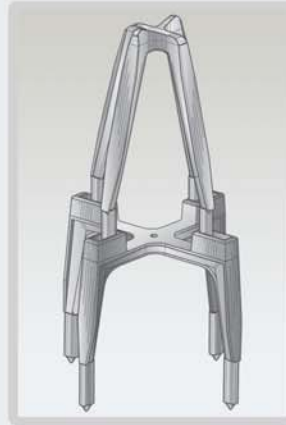

212 series GTI Single Lock Paving Chair

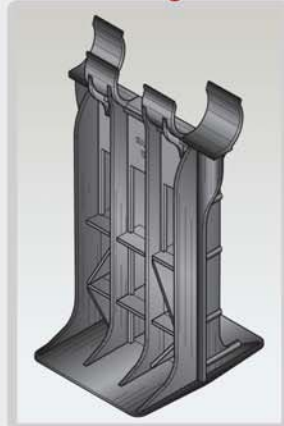

217 series GTI Double Lock Paving Chair

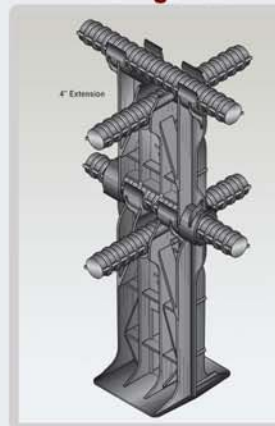



GENERAL TECHNOLOGIES, INC.

GTI COMPOSITES ARE STRONGER THAN METAL

Future Technology - Available Today

***GTI Composite
Upper 3.0"***

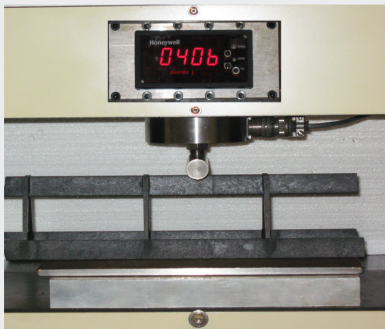

***Metal
Upper 3.0"***

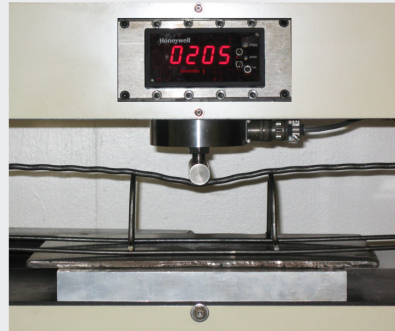

***GTI Composite
Slab/Beam Bolster 2.0"***



***Metal
Slab Bolster 2.0"***



***GTI Composite
216 PC Chair***



***Metal
Chair***





- Our Houston based 150,000 sq.ft. manufacturing facility.

**CORPORATE HEADQUARTERS, MANUFACTURING CENTER
& SOUTHWESTERN DISTRIBUTION CENTER**

HOUSTON

13022 Trinity Drive, Stafford, TX 77477 / Tel: (281) 240-0550 / Fax: (281) 240-0990 / www.gti-usa.net

Greg Reese, National Sales Manager – e-mail: greese@gti-usa.net – Cell: (703) 980-8174

Scott Griffin, SW Regional Sales Manager – e-mail: sgriffin@gti-usa.net – Cell: (281) 245-7324

SOUTHEASTERN U.S.

FLORIDA

9272 NW 101st Street
Medley, FL 33178
Tel: (305) 888-3374
Fax: (305) 888-3822

Deborah Nowosad
Florida Sales Manager
e-mail: dnowosad@gti-usa.net

MID-ATLANTIC U.S.

VIRGINIA

10501 Furnace Road, Suite 102
Lorton, VA 22079
Tel: (703) 495-8507
Fax: (703) 495-8509

Angela Dent
Location Manager
e-mail: adent@gti-usa.net

CENTRAL U.S.

CHICAGO

903 Wesemann Drive
West Dundee, IL 60118
Tel: (847) 241-2692
FAX: (847) 241-2694

Bob Jorgensen
Midwest Regional Sales Manager
e-mail: bjorgenson@gti-usa.net

Call your local bar support provider.